

## Condensate Pots (Seal Pots) (PA060)

### Applications

- Condensate pots are protecting the pressure instrument from the effect of hot pressure media like steam.
- Typical industry applications include Refineries, power plant, chemical&petrochemical, steel plants and other process industries.



### Ordering Information for PA060 Series

Model	Description		
PA060	Condensate Pots (Seal Pots)		
Model	Mounting Type		
1	Globe Type 3" Sch40		
2	Globe Type 3" Sch80		
3	Globe Type 3" Sch160		
Code	Material		
B	304 SS		
C	316 SS		
O	Others		
Code	Gauge Connection Style	Code	Gauge Connection Size
2	PT ("R" in ISO Standard)	D	3/8"
3	PF ("G" in ISO Standard)	F	1/2"
4	NPT	O	Others
X	Others		
Code	Process Connection Style	Code	Process Connection Size
2	PT ("R" in ISO Standard)	D	3/8"
3	PF ("G" in ISO Standard)	F	1/2"
4	NPT	O	Others
X	Others		

Sample Model Selection : PA064B2F2F

\* The standard specification and price are subject to change without prior notice

## Condensate Pots (Seal Pots) (PA060)

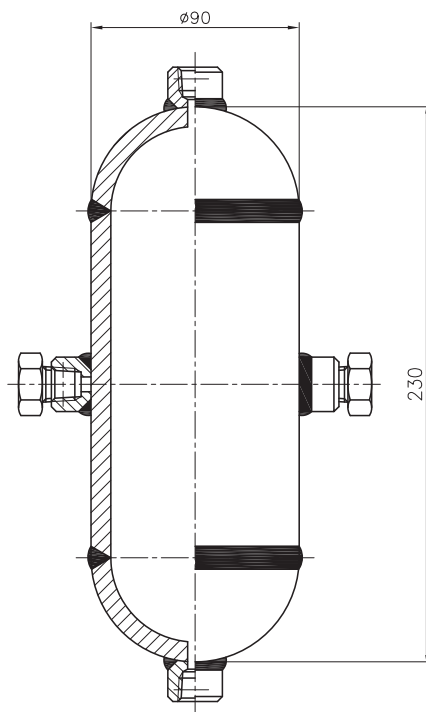

**HISCO** HISCO, INC.

32, Seonyu-ro 43-gil, Yeongdeungpo-gu, Seoul, Korea  
T : 82-2-2677-6046 F : 82-2-2672-1873 <http://www.hiscoi.com>